

POSIFLEX

Flexible! Powerful! Elegant!



XT-5317

High-End Fanless POS Terminal

XT-5317



In today's retail and hospitality markets, POS terminal is no longer just a cold and hard business tool. It is a part of the store decoration, a part of the store image. Each curve and detail of the POS terminal should add something to the overall mood of the store, to lift the shopping experience of customers.

The XT-5317 features a large 17" true-flat PCAP touch screen, beautifully sculptured slim body, and sexily curved base stand, it looks right at home at any elegantly decorated store. More than just good looks, the XT-5317 offers ample of performance and flexibility to satisfy the most demanding of daily POS operations.

Sleek Look

The XT-5317 comes from new Posiflex design language. Slimmer than ever, it is a sharp departure from the traditionally conservative Posiflex terminal design. Every curve and detail of the XT-5317 is carefully thought out to make itself one of the most visually desirable terminals in the market.

Scalable Performance

A wide range of CPU options from Intel Celeron to Core i3 to fit each unique need.

Multi-Position Folding Base (U.S. Patent 9004436)

The XT-5317 provides the selection of two foldable bases, the curvy slim GEN7E base and the larger but practical GEN8E base. The foldable base can be configured into "Flat Folded Mode" to save the shipping package volume, "Low Profile Mode" to allow greater interaction between the cashier and the customer, and the traditional "Full Extended Mode". All this can be achieved with a simple pull of the hidden lever.



Full Extended Mode



Low Profile Mode



Flat Folded Mode



Patented Fanless Technology

Solve the fan maintenance issue and provide silent mode operation, which is ideally suited for high-end boutique stores or hospital environments.

GEN8E Base [U.S. Patent 9004436]

Optional GEN8E base integrates internal power adaptor and PoweredUSB port into the base stand, which keeps counters clutter-free.

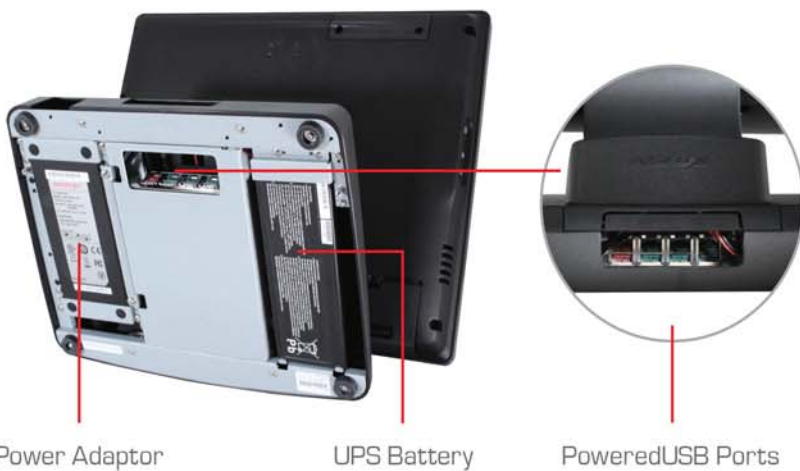

Power Adaptor

UPS Battery

PoweredUSB Ports

XT-5317

Specification

XT-5317

Processor	Intel Haswell G1820 CPU, 2.70 GHz, 2M Cache; Intel Haswell G3320TE CPU, 2.30 GHz, 3M Cache; Intel Haswell Core i3-4330TE CPU, 2.40 GHz, 4M Cache
System Memory	DDR3L SO-DIMM x 2, max. 16GB
Storage Device	SATA storage x 2
Power Supply	12V/130W
OS Support	Win 7/POSReady 7/WE 8.1 Industry/Win 10 IoT/Linux per request

Display & Touch

LCD	17" TFT LCD
Resolution	1280 x 1024
Touch	True-flat PCAP touch with multi-touch support (IP65 on front panel)

I/O & Expansion

Serial Port	6, DB9 x 2 + RJ45 x 2, pin header x 2 from service window, 5V support on all COM ports, 12V support on COM 1 to COM 4
Parallel Port	1, via optional conversion cable through service window
Standard USB Port	8, USB 3.0 x 2 + USB 2.0 x 6
PoweredUSB Port	Optional 24V x 1 + 12V x 3 via GENBE base
LAN Port	10/100/1000 Mb x 2
Display Port	VGA x 1, 12V support for Posiflex monitors; mini-DP x 1 on service window
CR Port	1, control 2 CR via optional Y-cable
PS/2 Port	1, via optional conversion cable through service window
UPS Port	Yes
Audio	Internal 2W speaker x 1 + Line-out
Expansion Slot	Mini-PCIe slot x 1

Physical Dimension

Dimension (W x D x H in mm)	404.5 x 355 x 251
Weight (N. W. in kg)	6.2

Environmental

Operating Condition	0°C - 40°C, 20%RH - 90%RH (Equipped with HDD); 0°C - 50°C, 20%RH - 90%RH (Equipped with SSD)
Storage Condition	-20°C - 70°C, 10%RH - 90%RH

Built-in Options

WiFi	Mini-PCIe WiFi/BT module
------	--------------------------

Attachment Options

POS Monitor	Non-touch TFT LCD: 7" (bezel type)/9.7" (bezel-free/bezel type)/12.1"/14" (bezel-free)/15" (bezel-free/bezel type); PCAP touch TFT LCD: 9.7"/14"/15"; Resistive touch TFT LCD: 15"
Line Display	2 x 20 rear-mount VFD/LCD customer line display; 7" color LCD graphical customer line display
Peripherals	MSR; iButton; Rotatable 2D scanner; RFID; Fingerprint Sensor; Key Keypad

*Designed and Manufactured in Taiwan by Posiflex Technology, Inc.

*The product information and specifications are subject to change without prior notice.

*Please refer to the website for more attachment options.

Certifications



EN201710V2

POSIFLEX

POSIFLEX TECHNOLOGY, INC.

No. 23, Datong St., Tucheng Dist., New Taipei City 23679, Taiwan

Tel : +886-2-2268-5577 E-mail : sales@posiflex.com.tw

Fax : +886-2-2268-5388 www.posiflex.com

Authorized Distributor / Reseller